

revisions		
DATE	NAME	DESCRIPTION
9-24-06	Angel	INITIAL COMPLETE (REVISED)

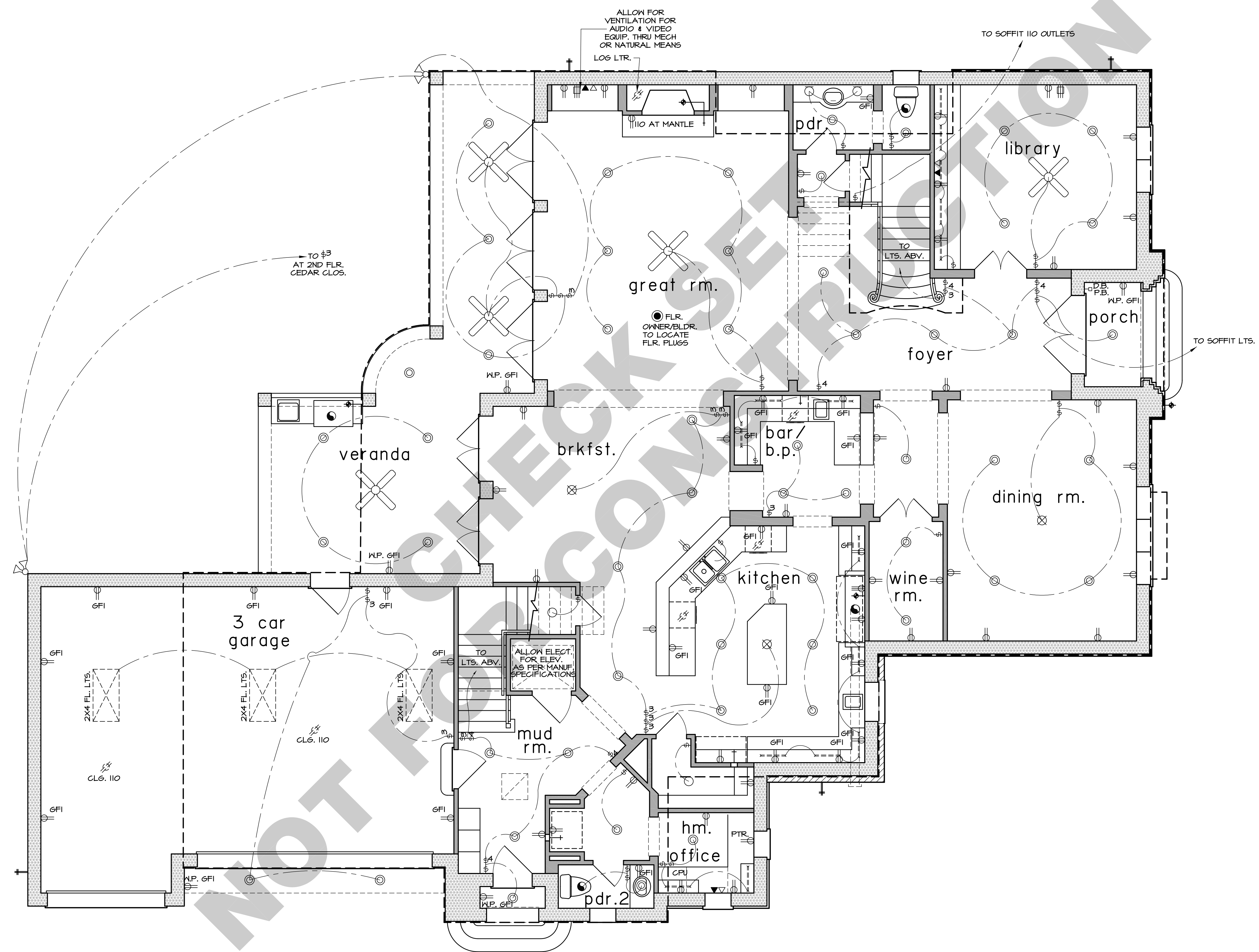

legend

- ⊕ 110 VOLT RECEPTACLE
- ⊕ W.P. WATERPROOF RECEPTACLE
- ⊕ G.F.I. 110 VOLT W/ GROUND FAULT INTERRUPTOR
- FLR. 110 VOLT IN FLOOR
- ⊕ 220 VOLT RECEPTACLE
- ⊕ TELEVISION ANTENNA
- ▼ TELEPHONE OUTLET
- ▽ NETWORK CABLE
- ⊕ SINGLE POLE SWITCH
- ⊕<sup>3</sup> THREE WAY SWITCH
- ⊕<sup>4</sup> FOUR WAY SWITCH
- ⊕ DIM DIMMER SWITCH
- ⊕ P.B. PUSH BUTTON
- ⊕ S.D. SMOKE DETECTOR
- CEILING MOUNTED LIGHT FIXTURE
- ⊗ CEILING MOUNTED HANGING FIXTURE
- ⊙ RECESSED CAN LIGHT
- ⊙ RECESSED PIN SPOT LIGHT
- ⊙ W.P. WATERPROOF RECESSED CAN LIGHT
- ⊙ RECESSED EYEBALL SPOT LIGHT
- WALL MOUNTED LIGHT FIXTURE
- ⊕ FLOOD LIGHTS
- ⊕ EXHAUST FAN
- ⊗ CEILING FAN
- ⊗ CEILING FAN W/ LIGHT
- ⊕ FLUORESCENT LIGHT PANEL
- ⊕ UNDER COUNTER FLUORESCENT LT.
- ⊗ BLOCK 4 WIRE FOR FAN W/LT

notes

- SMOKE DETECTORS REQUIRE 110V TO HOUSE WIRING W/ BATTERY BACKUP AND ARE INTERCONNECTED.
- VENT ALL EXHAUST FANS TO OUTSIDE
- PROVIDE G.F.I. PROTECTION AS REQ'D.
- PROVIDE LIGHT FIXTURE AND SMOKE DETECTORS AT EACH WATER HEATER AND A/C UNIT LOCATION IN ATTIC
- PROVIDE ELECTRIC DISCONNECT AT EACH A/C UNIT
- ALLOW FOR A/C UNITS
- PROVIDE LOW VOLTAGE CIRCUITS FOR BURGLAR ALARM SYSTEM
- PROVIDE LOW VOLTAGE CIRCUITS FOR INTERCOM SYSTEM W/ BASE AND SPEAKER LOCATIONS BY OWNER
- PROVIDE CIRCUITS FOR FUTURE POOL AND REAR YARD LIGHTING
- DIMMERS AT ALL BEDROOMS, DINING, LIBRARY, GAME ROOM, COMP. ALCOVE & KITCHEN.
- PROVIDE NETWORK JACKS AS PER OWNER
- OUTLETS AT BEDROOMS TO BE ARC PROTECTED AND ON SEPERATE CIRCUITS FROM CLG. FANS.

first electrical plan

SCALE: 1/4" = 1'-0"